

## TechClad™ at a glance

- > Instantly increases building's R-Value & Fire Resistance
- > Customizable panel thickness to accommodate R-Value requirements
- > Easy to cut and modify panels on-site

TechClad™ is a prefabricated insulated sheathing system that enhances thermal performance, fire protection, and structural integrity in both new and existing builds. Its magnesium oxide cement core and integrated insulation options reduce thermal bridging, improve energy efficiency, and streamline installation without the need for extra framing.

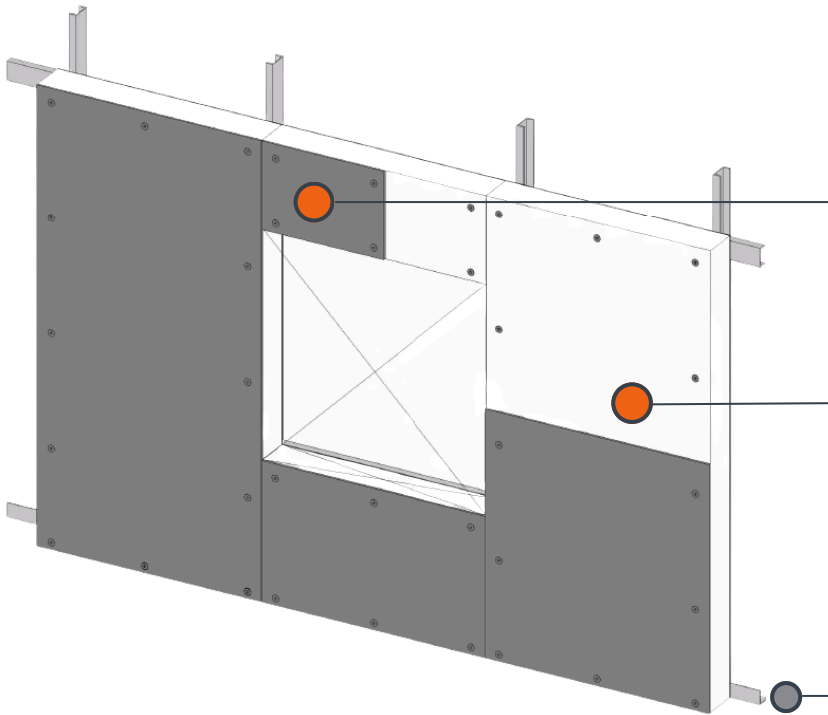

### Protective Sheathing

Magnesium cement (MgO) board (ZS2 TechBoard®)

### Thermal Insulation

Three types of EPS (Expanded Polystyrene) or Rockwool Comfortboard 80® available based on design specifications

### Structural Framing

Steel or Wood structure  
\*By others. Not as part of ZS2 TechClad assembly



B1141 / QAI  
CERus-1009

### Material Properties

12 24.305  
**Mg**  
Magnesium  
[Ne] 3s<sup>2</sup>  
Alkaline Earth Metal

The performance advantages of advanced MgO cement technology

- Fire resistant
- Water resistant
- Mold resistant
- Pest resistant
- Humidity control
- Non-Toxic

### Onsite Benefits



Where the benefits of offsite construction meet onsite efficiency

- Less waste
- Quality control
- Cost Certainty
- Reduced labor
- Reduced project schedule

### Sustained Value



Reduce risk, while delivering lasting value from construction through operation.

- Sustainable Material
- Climate Resilient
- Structural Integrity
- Lower Operational Cost

# Frequently Asked Questions

## What are the key benefits of using TechClad™ in construction projects?

TechClad™ provides exceptional fire resistance, moisture protection, and long-lasting durability, making it a strong choice for high-performance building envelopes or retrofits. Its simple design and straightforward installation process help lower labor expenses and speed up project completion.

## What kind of projects is TechClad™ typically used for?

TechClad™ provides an insulated sheathing solution for virtually any construction project that needs a boost in R value and fire resistance. One of the most common uses is to enclose multi-storey wood and steel frame buildings with a pre-fabricated insulated sheathing that provides rapid installation with minimal labor, and is easily modified on site with basic hand tools. TechClad™ is also ideal for retrofitting existing buildings with an extra layer of insulation and fire resistance.

## What certifications or standards does TechClad™ meet?

TechClad™ meets rigorous industry standards through third-party certifications and in-house quality control, ensuring compliance with building codes from Type II to Type V construction. It is tested for fire resistance, thermal performance, and structural integrity to support both new builds and retrofit projects.

## Is TechClad™ customizable?

Every project is unique and TechClad™ is manufactured to meet the specific project specifications. The thickness of the insulation can be adjusted to meet R-value requirements, and our team will help determine the best size of TechClad™ sheets for your project (4'x8', 4'x9', or 4'x10').

## How is TechClad™ different from TechPanel®?

TechClad™ offers the same fire, water, and mold resistance as TechPanel®, but is not designed to be a structural component. Instead, it extends the benefits of ZS2's climate-smart technology to projects where TechPanel® is less suitable—like certain new builds or retrofits of existing structures needing improved energy and environmental performance.

## Where can I find technical documentation or support for TechClad™?

To take a deeper dive into TechClad™ application and data, view or download the product sheet, datasheet, and installation guides found under the Technical Documents section of the [TechClad™ webpage](#). For project-specific support, ZS2's technical team is available via email or phone.

## Where can I buy TechClad™?

With a trusted network of partners and regional specialists across North America, we'll make sure you have the right support for your location and project needs. To get started, we just need a few details to provide an accurate quote. Our team uses your architectural, electrical, and mechanical drawings to manufacture cladding panels with precision, guide you through the design optimization process, and coordinate delivery to keep your project on track. Whether you have napkin sketches or first draft drawings, we can help panelize your build.

## Have a project in mind? Get in touch.

ZS2 is a leader in magnesium cement (MgO) construction solutions. By combining climate-resilient innovation with the advantages of prefab construction, our (MgO) cement technology delivers unmatched durability, fire resistance, and low carbon solutions setting a new standard for sustainable and resilient construction practices.

